

# Palermo Collection

Palermo base, Rectangle Top

Conference Tables

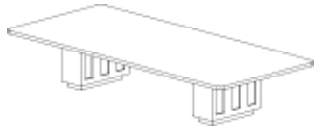

Size	Bases	Model code	LAMINATE				VENEER	
			T-mold (-LTM)	Self edge (-LSE)	3mm PVC (-LVE)	1-1/4" x 1-1/4" Wood edges (-LWE1)	Self edge (-VSE)	1-1/4" x 1-1/4" Wood edges (-VWE1)
30x60	2	1PQP360-	\$5,694	\$5,732	\$5,734	\$6,481	\$6,305	\$7,000
30x72	2	1PQP372-	\$5,740	\$5,775	\$5,782	\$6,583	\$6,372	\$7,084
30x84	2	1PQP384-	\$5,827	\$5,886	\$5,869	\$6,731	\$6,461	\$7,199
30x96	2	1PQP396-	\$5,906	\$5,903	\$5,895	\$6,768	\$6,063	\$6,703
30x120	2	1PQP320-	\$5,997	\$5,959	\$5,961	\$6,969	\$6,086	\$6,735
36x42	2	1PQP442-	\$5,682	\$5,734	\$5,718	\$6,376	\$6,355	\$7,058
36x48	2	1PQP448-	\$5,694	\$5,754	\$5,732	\$6,466	\$6,379	\$7,089
36x54	2	1PQP454-	\$5,749	\$5,788	\$5,786	\$6,558	\$6,459	\$7,192
36x60	2	1PQP460-	\$5,751	\$5,808	\$5,790	\$6,587	\$6,570	\$7,331
36x72	2	1PQP472-	\$5,808	\$5,843	\$5,848	\$6,706	\$6,490	\$7,240
36x84	2	1PQP484-	\$5,918	\$5,977	\$5,956	\$6,888	\$7,499	\$8,384
36x96	2	1PQP496-	\$5,996	\$5,964	\$5,953	\$6,931	\$6,605	\$7,378
36x120	2	1PQP420-	\$6,110	\$6,073	\$6,069	\$7,169	\$7,859	\$9,445
42x60	2	1PQP560-	\$5,898	\$5,848	\$5,849	\$6,697	\$6,434	\$7,158
42x72	2	1PQP572-	\$5,969	\$5,917	\$5,924	\$6,838	\$6,525	\$7,275
42x84	2	1PQP584-	\$6,107	\$6,080	\$6,055	\$7,060	\$6,656	\$7,437
42x96	2	1PQP596-	\$6,111	\$6,100	\$6,063	\$7,123	\$6,710	\$7,508
48x60	2	1PQP660-	\$5,900	\$5,848	\$5,853	\$6,736	\$6,468	\$7,204
48x72	2	1PQP672-	\$5,971	\$5,917	\$5,924	\$6,875	\$6,567	\$7,314
48x84	2	1PQP684-	\$6,109	\$6,080	\$6,059	\$7,102	\$6,741	\$7,530
48x96	2	1PQP696-	\$6,137	\$6,100	\$6,067	\$7,170	\$6,799	\$7,606
48x108	2	1PQP608-	\$6,251	\$6,218	\$6,202	\$7,399	\$8,195	\$9,245
48x120	2	1PQP620-	\$6,255	\$6,238	\$6,210	\$7,466	\$8,210	\$9,322
48x144*	3	1PQP644-	\$9,245	\$9,276	\$9,249	\$11,145	\$11,395	\$12,617
48x168*	3	1PQP668-	\$9,521	\$9,577	\$9,518	\$11,621	\$11,666	\$12,980
48x192*	3	1PQP692-	\$9,528	\$9,597	\$9,534	\$11,760	\$11,785	\$13,135
48x216*	4	1PQP616-	\$12,451	\$12,499	\$12,404	\$14,862	\$15,497	\$17,068
48x240*	4	1PQP640-	\$12,458	\$12,524	\$12,466	\$14,996	\$15,614	\$17,221
48x288*	5	1PQP688-	\$15,479	\$15,621	\$15,558	\$18,658	\$18,917	\$20,688
60x84	2	1PQP784-	\$6,777	\$6,748	\$6,723	\$7,905	\$7,921	\$8,856
60x96	2	1PQP796-	\$6,781	\$6,768	\$6,732	\$7,987	\$8,040	\$9,005
60x108	2	1PQP708-	\$6,953	\$6,920	\$6,897	\$7,941	\$9,742	\$10,998
60x120	2	1PQP720-	\$6,956	\$6,940	\$6,906	\$8,346	\$9,757	\$11,086
60x144*	3	1PQP744-	\$10,245	\$10,278	\$10,241	\$12,353	\$13,247	\$14,698
60x168*	3	1PQP768-	\$10,588	\$10,648	\$10,573	\$12,934	\$13,581	\$15,133
60x192*	3	1PQP792-	\$10,596	\$10,668	\$10,590	\$13,094	\$13,719	\$15,314
60x216*	4	1PQP716-	\$13,850	\$13,903	\$13,833	\$16,564	\$18,155	\$20,063
60x240*	4	1PQP740-	\$13,858	\$13,923	\$13,849	\$16,724	\$18,407	\$20,599
60x288*	5	1PQP788-	\$17,211	\$17,335	\$17,269	\$20,777	\$21,946	\$24,119

\*Indicates multiple piece top

**Palermo Base Options**  
(all options per base)

\*\*Palermo Bases only available in veneer\*\*

Acrylic Inserts .....Standard

Laminate Inserts .....  
.....Subtract \$540

Veneer Inserts .....  
.....Subtract \$402

Metal Laminate Inserts .....  
.....Subtract \$274

Satin Silver Toe Kick .....  
.....Standard

**Edge Options**

Flat T-Mold (-T10)    Bumper T-Mold (-T14)    Bullnose T-Mold (-T35)    Flat 3mm PVC (-T33)    Laminate Self Edge (-T13)    Veneer Self Edge (-V13)

Beveled Wood Edge 1-1/4" x 1-1/4" (-T63-BV) 2" x 1-1/4" (-T64-BV) 2" x 1-3/4" (-T65-BV)

Bullnose Wood Edge 1-1/4" x 1-1/4" (-T63-BN) 2" x 1-1/4" (-T64-BN) 2" x 1-3/4" (-T65-BN)

Knife Wood Edge 1-1/4" x 1-1/4" (-T63-KN) 2" x 1-1/4" (-T64-KN) 2" x 1-3/4" (-T65-KN)

Ogee Wood Edge 1-1/4" x 1-1/4" (-T63-OG) 2" x 1-1/4" (-T64-OG) 2" x 1-3/4" (-T65-OG)

Reeded Wood Edge 1-1/4" x 1-1/4" (-T63-RD) 2" x 1-1/4" (-T64-RD) 2" x 1-3/4" (-T65-RD)

Square Wood Edge 1-1/4" x 1-1/4" (-T63-SQ) 2" x 1-1/4" (-T64-SQ) 2" x 1-3/4" (-T65-SQ)

Waterfall Wood Edge 1-1/4" x 1-1/4" (-T63-WF) 2" x 1-1/4" (-T64-WF) 2" x 1-3/4" (-T65-WF)

**Extras**

Metal insert...\$50  
Table locks ..\$116  
Custom cut out....\$210  
Grommets .....\$60

Self-adjusting glides .....\$40  
Undertable Wire management .....\$75  
Vertical Wire management .....\$25

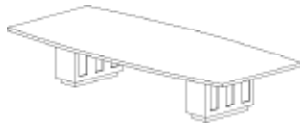

Racetrack and Teledwedge tops are available for the same price as boat tops. Replace "A" in model code with either "O" for racetrack or "S" for teledwedge.

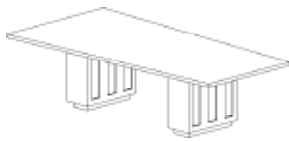
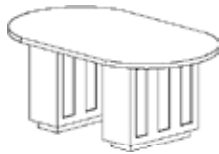

Size	Bases	Model code	LAMINATE				VENEER	
			T-mold (-LTM)	Self edge (-LSE)	3mm PVC (-LVE)	1-1/4" x 1-1/4" Wood edges (-LWE1)	Self edge (-VSE)	1-1/4" Wood edges (-VWE1)
30x60	2	1PQA360-	\$5,768	\$6,000	\$5,980	\$6,774	\$6,587	\$7,327
30x72	2	1PQA372-	\$5,814	\$6,043	\$6,027	\$6,875	\$6,654	\$7,412
30x84	2	1PQA384-	\$5,902	\$6,154	\$6,114	\$7,024	\$6,744	\$7,526
30x96	2	1PQA396-	\$5,906	\$6,174	\$6,123	\$7,075	\$6,787	\$7,584
30x120	2	1PQA320-	\$5,997	\$6,241	\$6,218	\$7,275	\$7,499	\$8,601
36x42	2	1PQA442-	\$5,756	\$6,002	\$5,963	\$6,668	\$6,342	\$7,223
36x48	2	1PQA448-	\$5,769	\$6,022	\$5,978	\$6,759	\$6,369	\$7,062
36x54	2	1PQA454-	\$5,823	\$6,057	\$6,032	\$6,850	\$6,637	\$7,386
36x60	2	1PQA460-	\$5,825	\$6,077	\$6,036	\$6,879	\$6,662	\$7,416
36x72	2	1PQA472-	\$5,882	\$6,111	\$6,094	\$6,999	\$6,741	\$7,520
36x84	2	1PQA484-	\$5,992	\$6,245	\$6,202	\$7,181	\$6,852	\$7,658
36x96	2	1PQA496-	\$5,996	\$6,265	\$6,210	\$7,237	\$6,900	\$7,722
36x120	2	1PQA420-	\$6,110	\$6,354	\$6,326	\$7,476	\$7,859	\$9,662
42x60	2	1PQA560-	\$5,898	\$6,129	\$6,106	\$7,002	\$6,729	\$7,502
42x72	2	1PQA572-	\$5,969	\$6,198	\$6,178	\$7,146	\$6,821	\$7,619
42x84	2	1PQA584-	\$6,107	\$6,754	\$6,312	\$7,368	\$6,952	\$7,781
42x96	2	1PQA596-	\$6,111	\$6,361	\$6,320	\$7,431	\$7,006	\$7,850
48x60	2	1PQA660-	\$5,900	\$6,129	\$6,110	\$7,043	\$6,764	\$7,548
48x72	2	1PQA672-	\$5,971	\$6,198	\$6,182	\$7,181	\$6,861	\$7,658
48x84	2	1PQA684-	\$6,109	\$6,361	\$6,316	\$7,409	\$7,037	\$7,872
48x96	2	1PQA696-	\$6,137	\$6,381	\$6,324	\$7,478	\$7,096	\$7,950
48x108	2	1PQA608-	\$6,251	\$6,499	\$6,459	\$7,705	\$8,195	\$9,462
48x120	2	1PQA620-	\$6,255	\$6,519	\$6,467	\$7,774	\$8,210	\$9,537
48x144*	3	1PQA644-	\$9,245	\$9,642	\$9,584	\$11,546	\$11,395	\$13,379
48x168*	3	1PQA668-	\$9,521	\$9,943	\$9,853	\$12,024	\$11,666	\$13,739
48x192*	3	1PQA692-	\$9,528	\$9,963	\$9,869	\$12,162	\$11,785	\$13,894
48x216*	4	1PQA616-	\$12,451	\$12,865	\$12,739	\$15,263	\$15,497	\$17,829
48x240*	4	1PQA640-	\$12,458	\$12,890	\$12,801	\$15,399	\$15,614	\$17,980
48x288*	5	1PQA688-	\$15,421	\$15,937	\$15,847	\$19,451	\$18,917	\$22,036
60x84	2	1PQA784-	\$6,777	\$7,029	\$6,980	\$8,212	\$8,217	\$9,201
60x96	2	1PQA796-	\$6,781	\$7,049	\$6,989	\$8,294	\$8,336	\$9,348
60x108	2	1PQA708-	\$6,953	\$7,202	\$7,155	\$8,573	\$9,742	\$11,215
60x120	2	1PQA720-	\$6,956	\$7,222	\$7,163	\$8,652	\$9,757	\$11,303
60x144*	3	1PQA744-	\$10,245	\$10,644	\$10,576	\$12,764	\$13,247	\$15,460
60x168*	3	1PQA768-	\$10,588	\$11,014	\$10,908	\$13,345	\$13,581	\$15,893
60x192*	3	1PQA792-	\$10,596	\$11,214	\$10,925	\$13,507	\$13,719	\$16,073
60x216*	4	1PQA716-	\$13,850	\$14,270	\$14,168	\$16,967	\$18,155	\$20,822
60x240*	4	1PQA740-	\$13,858	\$14,290	\$14,184	\$17,127	\$18,407	\$21,001
60x288*	5	1PQA788-	\$17,153	\$17,651	\$17,558	\$21,571	\$21,946	\$25,467

\*Indicates multiple piece top

Palermo Base Options  
(all options per base)

\*\*Palermo Bases only available in veneer\*\*

Acrylic Inserts .....Standard

Laminate Inserts .....  
.....Subtract \$540

Veneer Inserts .....  
.....Subtract \$402

Metal Laminate Inserts .....  
.....Subtract \$274

Satin Silver Toe Kick .....  
.....Standard

Work Surface Material Options

Thermofoil

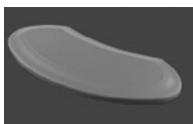

Same Price as T-Mold  
Add \$180 list per order  
for boat, racetrack &  
teledwedge tops

Marmoleum



Add \$11 list  
per square foot to  
Laminate Pricing

Lightweight

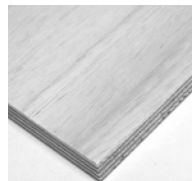

Add \$14 list  
per square foot

Bamboo



See page 95  
for pricing

Cambria



C A M B R I A

Add \$165 list  
per square foot to  
3mm Laminate Pricing

Extras

Metal insert...\$50  
Table locks ..\$116  
Custom cut out....\$210 Grommets .....\$60

Self-adjusting glides .....\$40  
Undertable Wire management .....\$75  
Vertical Wire management .....\$25