

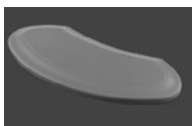

BAMBOO						
Size	Pieces	Model code	Amber Edge	Havana &		
			Grain/Flat Grain (-BA)	Sahara (-BH/S)	Neopolitan (-BN)	
18x24	1	1P124-	\$570	\$625	\$645	
18x36	1	1P136-	\$793	\$766	\$797	
18x48	1	1P148-	\$800	\$1,178	\$1,240	
18x54	1	1P154-	\$1,239	\$1,185	\$1,247	
18x60	1	1P160-	\$1,248	\$1,194	\$1,256	
18x72	1	1P172-	\$1,262	\$1,208	\$1,270	
18x84	1	1P184-	\$1,277	\$2,033	\$1,576	
18x96	1	1P196-	\$1,280	\$2,036	\$1,578	
24x30	1	1P230-	\$790	\$764	\$794	
24x36	1	1P236-	\$800	\$774	\$804	
24x42	1	1P242-	\$810	\$1,188	\$1,250	
24x48	1	1P248-	\$820	\$1,198	\$1,260	
24x54	1	1P254-	\$1,262	\$1,208	\$1,270	
24x60	1	1P260-	\$1,272	\$1,218	\$1,280	
24x72	1	1P272-	\$1,293	\$1,239	\$1,301	
24x84	1	1P284-	\$1,313	\$2,068	\$2,192	
24x96	1	1P296-	\$1,320	\$2,075	\$2,199	
30x36	1	1P336-	\$1,248	\$1,194	\$1,255	
30x42	1	1P342-	\$1,260	\$2,016	\$2,140	
30x48	1	1P348-	\$1,272	\$2,027	\$2,150	
30x54	1	1P354-	\$2,147	\$2,040	\$2,163	
30x60	1	1P360-	\$2,160	\$2,053	\$2,176	
30x72	1	1P372-	\$2,186	\$2,078	\$2,202	
30x84	1	1P384-	\$2,211	\$3,722	\$3,970	
30x96	1	1P396-	\$2,223	\$3,734	\$3,981	
36x42	1	1P442-	\$1,277	\$2,033	\$2,156	
36x48	1	1P448-	\$1,293	\$2,049	\$2,172	
36x54	1	1P454-	\$2,170	\$2,063	\$2,186	
36x60	1	1P460-	\$2,186	\$2,079	\$2,202	
36x72	1	1P472-	\$2,216	\$2,109	\$2,261	
36x84	1	1P484-	\$2,245	\$3,757	\$4,003	
36x96	1	1P496-	\$2,269	\$3,780	\$4,027	
42x54	1	1P554-	\$2,191	\$2,084	\$2,207	
42x60	1	1P560-	\$2,199	\$2,091	\$2,214	
42x72	1	1P572-	\$2,234	\$2,127	\$2,250	
42x84	1	1P584-	\$2,269	\$2,700	\$4,026	
42x96	1	1P596-	\$2,304	\$2,736	\$4,061	
48x60	1	1P660-	\$2,223	\$2,115	\$2,239	
48x72	1	1P672-	\$2,264	\$2,156	\$2,280	
48x84	1	1P684-	\$2,303	\$3,815	\$4,061	
48x96	1	1P696-	\$2,343	\$3,854	\$4,101	

Work Surface Material Options

Thermofoil



Same Price as T-Mold
Add \$180 list per order
for boat, racetrack &
telewedge tops

Marmoleum



Add \$11 list
per square foot to
Laminate Pricing

Lightweight

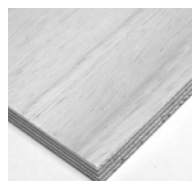

Add \$14 list
per square foot

Bamboo

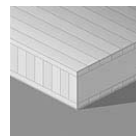

See page 95
for pricing

Cambria



Add \$165 list
per square foot to
3mm Laminate Pricing

Extras

Anti-Sag bar\$96

Custom cut out\$210 Custom stain..\$445

Flat plate\$25 Grommet.....\$60

Table locks ..\$116

Click-Catch Locks ...\$28 Metal insert...\$50

Tops Only

Bamboo, Boat Shape



Racetrack and Teledge tops are available for the same price as boat tops. Replace "A" in model code with either "O" for racetrack or "S" for teledge.



BAMBOO					
Size	Pieces	Model code	Amber Edge	Havana &	
			Grain/Flat Grain (-BA)	Sahara (-BH/S)	Neopolitan (-BN)
30x60	1	1A360-	\$2,262	\$2,155	\$2,278
30x72	1	1A372-	\$2,288	\$2,180	\$2,304
30x84	1	1A384-	\$2,312	\$3,823	\$4,070
30x96	1	1A396-	\$2,325	\$3,836	\$4,083
36x42	1	1A442-	\$2,243	\$2,135	\$2,258
36x48	1	1A448-	\$2,257	\$2,149	\$2,273
36x54	1	1A454-	\$2,272	\$2,165	\$2,288
36x60	1	1A460-	\$2,288	\$2,180	\$2,304
36x72	1	1A472-	\$2,318	\$2,210	\$2,334
36x84	1	1A484-	\$2,347	\$3,859	\$4,105
36x96	1	1A496-	\$2,366	\$3,877	\$4,124
42x54	1	1A554-	\$2,277	\$2,169	\$2,292
42x60	1	1A560-	\$2,300	\$2,193	\$2,317
42x72	1	1A572-	\$2,335	\$2,227	\$2,351
42x84	1	1A584-	\$2,370	\$3,881	\$4,128
42x96	1	1A596-	\$2,406	\$3,916	\$4,164
48x60	1	1A660-	\$2,325	\$2,217	\$2,341
48x72	1	1A672-	\$2,366	\$2,259	\$2,382
48x84	1	1A684-	\$2,421	\$3,932	\$4,179
48x96	1	1A696-	\$2,445	\$3,957	\$4,203

Squares



BAMBOO					
Size	Pieces	Model code	Amber Edge	Havana &	
			Grain/Flat Grain (-BA)	Sahara (-BH/S)	Neopolitan (-BN)
24X24	1	1R924-	\$536	\$590	\$611
30X30	1	1R930-	\$1,206	\$1,153	\$1,214
36X36	1	1R936-	\$1,235	\$1,180	\$1,243
42X42	1	1R942-	\$1,267	\$2,023	\$2,146
48X48	1	1R948-	\$1,304	\$2,060	\$2,183

Rounds



BAMBOO					
Size	Pieces	Model code	Amber Edge	Havana &	
			Grain/Flat Grain (-BA)	Sahara (-BH/S)	Neopolitan (-BN)
24	1	1Q924-	\$565	\$619	\$639
30	1	1Q930-	\$1,235	\$1,181	\$1,243
36	1	1Q936-	\$1,262	\$1,208	\$1,270
42	1	1Q942-	\$1,283	\$2,039	\$2,162
48	1	1Q948-	\$1,320	\$2,075	\$2,199

Edge Options

Flat T-Mold (-T10)	Bumper T-Mold (-T14)	Bullnose T-Mold (-T35)	Flat 3mm PVC (-T33)	Laminate Self Edge (-T13)	Veneer Self Edge (-V13)	Square Wood Edge (-T63-SQ)
Beveled Wood Edge (-T63-BV)	Bullnose Wood Edge (-T63-BN)	Knife Wood Edge (-T63-KN)	Ogee Wood Edge (-T63-OG)	Reeded Wood Edge (-T63-RD)	Waterfall Wood Edge (-T63-WF)	
1-1/4" x 1-1/4" (-T63-BV) 2" x 1-3/4" (-T64-BV) 2" x 1-3/4" (-T65-BV)	1-1/4" x 1-1/4" (-T63-BN) 2" x 1-3/4" (-T64-BN) 2" x 1-3/4" (-T65-BN)	1-1/4" x 1-1/4" (-T63-KN) 2" x 1-3/4" (-T64-KN) 2" x 1-3/4" (-T65-KN)	1-1/4" x 1-1/4" (-T63-OG) 2" x 1-3/4" (-T64-OG) 2" x 1-3/4" (-T65-OG)	1-1/4" x 1-1/4" (-T63-RD) 2" x 1-3/4" (-T64-RD) 2" x 1-3/4" (-T65-RD)	1-1/4" x 1-1/4" (-T63-WF) 2" x 1-3/4" (-T64-WF) 2" x 1-3/4" (-T65-WF)	

Extras

- Anti-Sag bar\$96
- Custom cut out\$210 Custom stain..\$445
- Flat plate\$25 Grommet.....\$60
- Table locks ..\$116
- Click-Catch Locks ...\$28 Metal insert...\$50