

Chat



Functional Collaboration Furniture

Surfacetech

Chat



Sit ... Stand ... Sprawl

Chat provides a standing, desk and occasional height table with clean power integration. Concealed casters are available, making Chat the ideal solution for your dynamic space. Chat is offered in a wide variety of laminate and veneer selections.

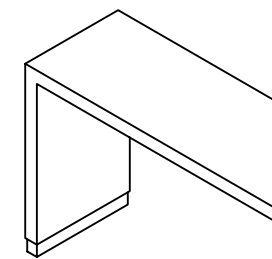

Plinth

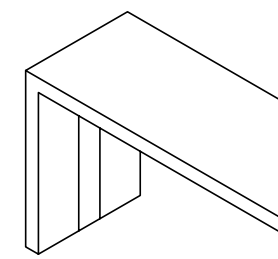

Vertical Hinged Door

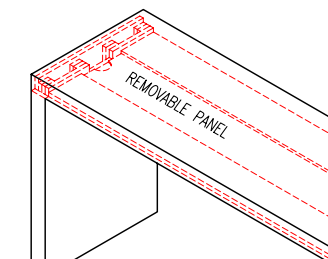

Removable Access Panel

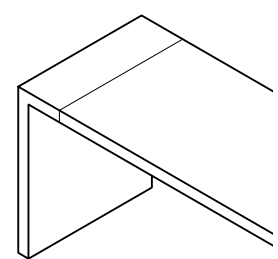

Mutli-piece available to ease installation

Surfacetech

www.surfacetech.com | (800) 241-2982 | fax (816) 231-1185 | 7106 E. Truman Rd. Kansas City, MO

Chat Media



Cube ... Cylinder ... Disc

Chat Media Collection offers three base selections to meet your client's look and budget. All three bases conceal wiring from floor core to table top. Disc and cube bases include a stainless-steel foot ring option that never chips like powder coat. Material choices include laminate (HPL & 3D), veneer and Cambria for tops.



Chat Empowered



Swivel
Empowered Swivel
Disc base includes solid
surface Ergo Edge top.

Power Options

Inform ... Evaluate ... Generate

Surfacetech power option enable teams to share information, consider content and build on existing information to create new solutions. Surfacetech works with several power component manufacturers. Our customer service team will help specify the right solution to meet your requirements. Or if the power already is provided, Surfacetech will make custom cutouts in the size, shape and placement needed.



Moiré

2 Power Outlets, 2 USB Charging

Recharge

People need an area to recharge smart phones, tablets and minds in today's work and learning spaces. The Chat Empowered Collection facilitates all three. Standard power options include USB charging. Hollow columns and large cut outs allow for flexible wire concealment.



Marina

"Show Me"
Collaboration Buttons

Cove
2 Power Outlets, 2 USB Charging





Surfacetech

www.surfacetech.com | (800) 241-2982 | fax (816) 231-1185 | 7106 E. Truman Rd. Kansas City, MO